

Beste mevrouw,

Bij deze nog informatie die volgens mij relevant is voor de raadsleden.

Met vriendelijke groet,

Jos Wolfs

---

From: eubasket@hotmail.com  
To: joswolfs@hotmail.com  
Subject: RE: New sportshal  
Date: Fri, 15 Jan 2016 12:10:36 +0100

Hi Jos,

The name of the company is HUPRO and you have portfolio about the company as well as all the details in the attachment.

OK, let me know how your meeting with council went. Be sure that this is the cheapest and the best quality kind of sports halls one can get. You can see all EU and ISO certificates in our portfolio, it is manufactured in EU and very quick to build, approx. 2-3 months.

Regards,

Bane

---

From: joswolfs@hotmail.com  
To: eubasket@hotmail.com  
Subject: RE: New sportshal  
Date: Fri, 15 Jan 2016 11:43:13 +0100

Hello Bane,

What's the name off your company?

On tuesday I will meet with all the people from the counsel off Maastricht.

They apply for a topsporthal which has to be voted for.

So after tuesday I'll contact you, thanks alot for the information.

Greetings,

Jos Wolfs

---

From: eubasket@hotmail.com  
To: joswolfs@hotmail.com; eurobasketnederland@hotmail.com  
Subject: RE: New sportshal  
Date: Wed, 13 Jan 2016 08:49:48 +0100

Hello Jos,

Nice to hear from you. I am glad you are doing well in basketball. So am I, very busy but all ok.

As regards sports facility I can offer you very nice sports facility and much, much cheaper then EUR 7,9 million. Our facilities are manufactured in EU (Slovakia) and they meet all EU standards and we hold all certificates for quality assurance. We built close to 3000 facilities around the World.

In the attachment you can see our latest facility that we we will be doing in London , dimensions 32m wide and 36m long. This facility has 1 main basketball court and 2 training courts with 300 seats for spectators. There is also 2 dressing rooms, 3 offices, reception area and storage. Please be aware that this is what we were asked to do and this is what buyer wants.

Every sports hall that we do is purely tailor made for the buyer and we will have no problem to do it according to your wish!

Images that I am sending to you are purely informative.

First 6 pictures are dimension 36m long and 32 m wide and the other 8 images are 72m long and 25m wide. As you can see one sports facility is split in 2 courts, one for games and one for training with annex in the middle with 4 dressing rooms, 2 offices and cafeteria on the top.

As I said, we have no problem to do for you what you exactly want and we can also provide visualization of the facility you want to build against the payment of EUR 600.

Estimated cost of sports facility that yo asked for 49m long, 30m wide and 9m high would be approximately € 2.700.000, subject to land survey (doing exact calculation about amount of concrete that we will need).

You can show these images to the people involved and if they like it we can make a meeting.

Best Regards,

Bane

From: joswolfs@hotmail.com  
To: eubasket@hotmail.com  
Subject: New sportshal  
Date: Tue, 12 Jan 2016 23:12:28 +0100

Hello Banne,

Long time ago hope every thing is going well for you.

I'am basketbal wise busy in Maastricht.

They are looking for a new sportshal.

The discussion is that we want internationaal standaards in there.

The gym is 49 meters bij 30 meters the hight is 9 meters.

6 locker rooms.

The hal will cost €7.900.000

Could you give a possible view off how much that will cost if you would have to do this.

Tomorrow I will get more details.

So if you sent me a list of questions than I can response to you quickly.

Warm regards,

Jos Wolfs





**CONTACT FOR HOLLAND:**

***BANE VUKOVIC***

**MOB: +356 99681677**

**MAIL: eubasket@hotmail.com**



**HUPRO ® Company, spol. s. r. o.** performs a unique technology of self-supporting steel arch structures, which has been a tradition since 1985. During this period we have carried out more than 2500 projects worldwide. This technology enables to overlay space width of 9 m to 50 m without any additional support structure. We offer you the opportunity to use our unique **system features 2-in-1**, where self-supporting structure serves as a roof coating, so you can achieve the profitability of the entire planned construction.



**In the manufacturing process**, our company uses only those materials that guarantee maximum weather resistance and chemical resistance, which significantly extends the maintenance-free system. We offer you a guarantee up to **25 years**.





ArcelorMittal

Aluzinc®

ArcelorMittal Flat Carbon Europe S.A. provides this warranty to

.....  
.....  
.....

hereafter referred to as the "Client"

relating to the quality of its Aluzinc® AZ185-type coated sheets. Subject to the conditions of this document, this warranty covers the structural integrity, in other words the non-perforation and non-rupture due to corrosion, of Aluzinc® steel sheet coated with 185 g/m<sup>2</sup> on both sides, used for building purposes both indoors and outdoors, for a period of 25 years, from the date of shipping by ArcelorMittal Dudelange.

ArcelorMittal Flat Carbon Europe S.A.

The Client

25 year warranty

Aluzinc® - Date

If the Client does not return the present document duly dated, initialed and signed by the authorised person(s) within thirty (30) days at the latest of the date of its receipt, the terms and conditions of the present document shall be deemed to have been expressly accepted in full by the Client.

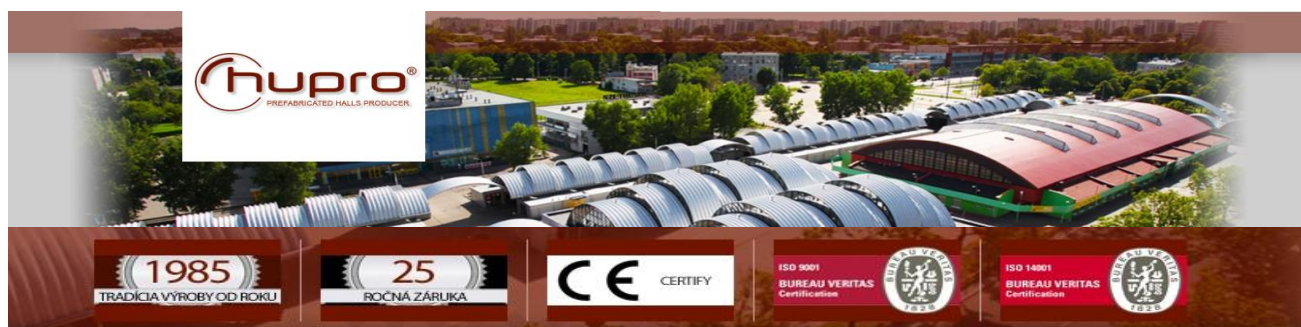

**HUPRO ® System is CE certified**, which ensures that the product that we offer, meets the most stringent criteria for both types of material used (Aluzinc®, stainless joints ...) as well as the production of construction and subsequent final inspection. We also hold ISO 9001 and ISO 14001.

**Our technology allows to construct** even on such places, where other types of prefabricated buildings and tent objects are not possible in terms of climatic snow loads and wind use. Possible climatic load of our system is to 600 kg/m<sup>2</sup>.

**HUPRO System** ® is characterized by maximum originality and attractive design, which is beyond uniformity of right angles and precisely for that reason it is widely used in the most complex architectural works.



**Technology** - Arch constructions are the most effective spatial structures. They are light, while staying extremely rigid and strong. Smart combination of static principles of vaults and shells (formed by longitudinal and transverse forming of the basic steel part in a shape of W) is easily applied especially for large spans using overlap area up to 50 meters in width. The basic part is made of structural steel S 320 coated by ALUZINC ®, thick from 0.8 mm to 2 mm, depending on the span of buildings and climate conditions of the construction site. Combining of individual parts is made with stainless steel joints. The



steel arch structure is anchored directly to the foundation using steel anchors. The advantage is also relatively lightweight steel structure in comparison to other building materials. This advantage brings significantly lower demands for the creation of the object and also reduces the cost of shipping and installation. Excellent static properties of the system are useful in extreme weather conditions, construction is resistant to earth shocks up to 7 of the Richter scale.

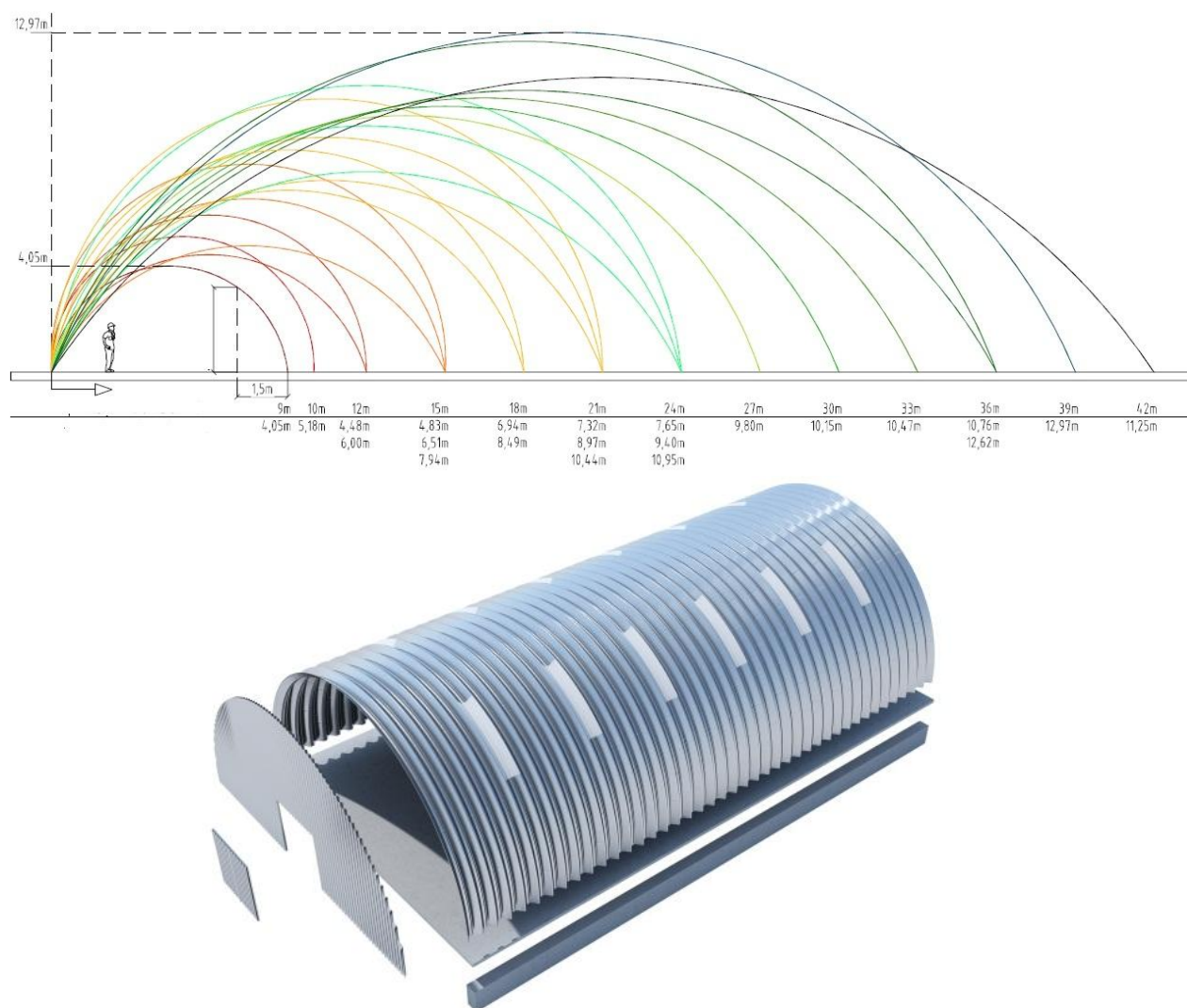

**Ventilation of a hall** - A hall is standardly equipped by a system of active ventilation. In case of thermally insulated building there is ventilation space between the inner shell of the hall and insulation with side suction fan at the bottom of the building's shell and active roof top fan Lomanco ® . This system is based on the principles of thermodynamics and provides sufficient ventilation of the space without the formation of excessive moisture.





**Illumination of a hall** - We use transparent panels Hupro ® of dimensions 2800 mm x 610 mm planted in a self-supporting shell of the building. In the fronts of the buildings it is possible to use normal windows or transparent belts.



**Insulation of a hall** - It can be done by multiple variants of isolation using different finishes on the interior facade of the building. By isolating of self-supporting construction we also achieve fire resistance throughout the building as required.

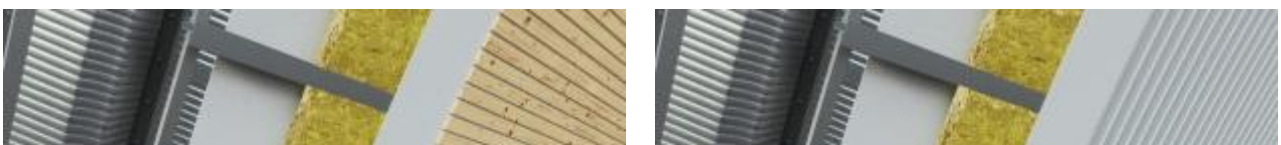

- Henging system
- Contact permeable film (foil)
- Construction system
- Mineral insulation or Polystyren
- Foil vapor barriere
- Fairfaced wooden pallet or Corrugated metal sheet interior

**Transport** - Basic parts of Hupro are delivered on pallets sized 700 x 3100 mm. On one pallet it is possible to ship such number of parts, which will cover about 100 m<sup>2</sup> ground-plan area after installation. One truck transports the material, which covers about 1,000 m<sup>2</sup> ground- plan area, which represents significant savings in transportation costs.



**Installation** - Individual basic components of the system are bonded by stainless steel joints, of which a compact unit is made in site after assembly. Installation- Individual units are then lifted by crane techniques and fixed by steel anchors into the foundation. The time of construction of a building with an area of 1,000 m<sup>2</sup> is normally realized within 14 days.



**Services** - We offer full design and supply service to you. We will visit you and help you with our experience and expertise to implement your ideas. Our designing team can make a free hall study and after its approval, we can proceed with design documents.



## SPORTS HALLS



